

Schedule 1
 Map of Agreement Area

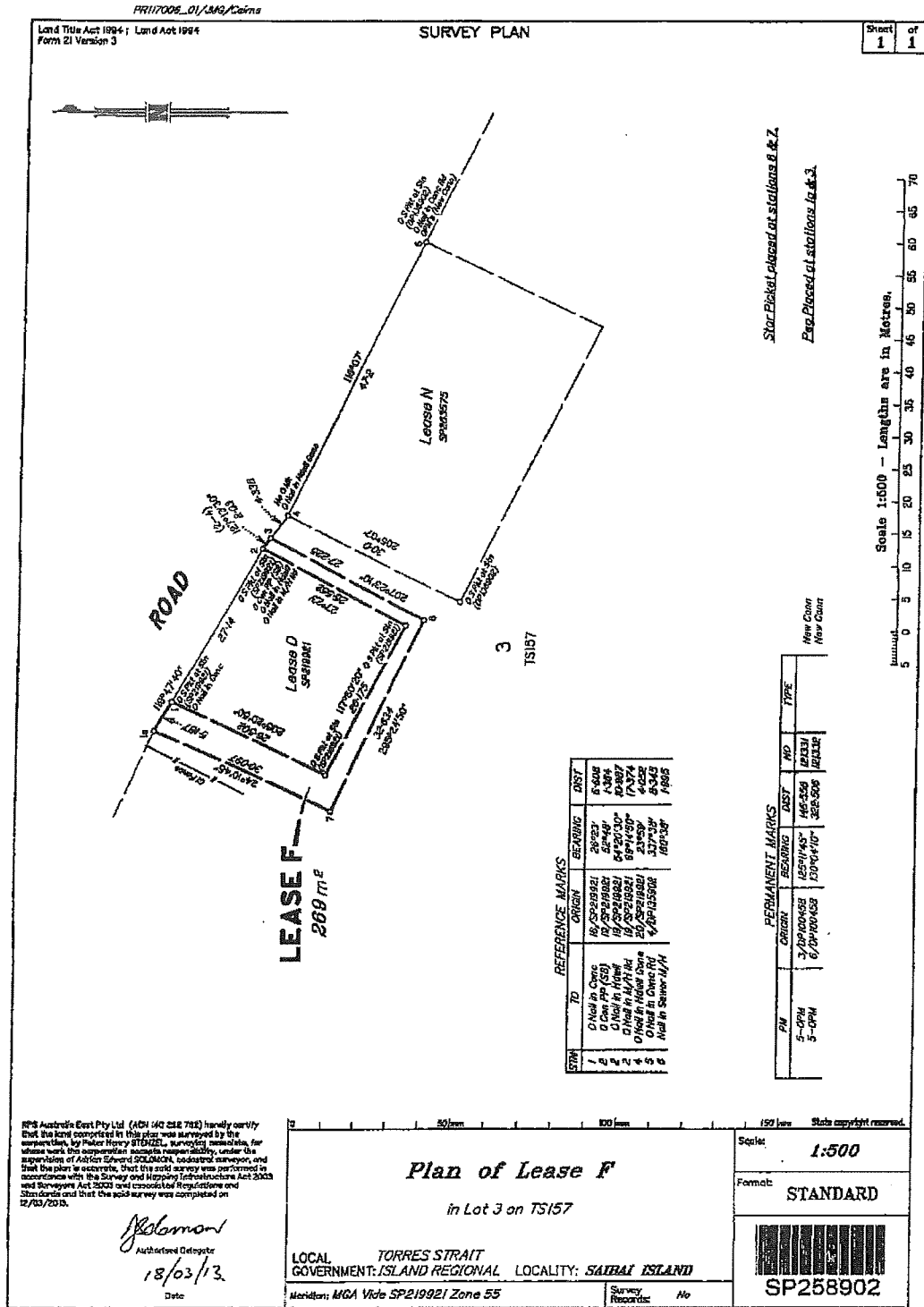

(Dealing No.)		WARNING : Folded or Mutilated Plans will not be accepted. Plans may be rolled. Information may not be placed in the outer margins.																
1. Certificate of Registered Owners or Lessees. S/W/ <u>TORRES STRAIT ISLAND REGIONAL COUNCIL</u> <u>DEED OF GRANT IN TRUST</u> <u>THE GRANTEE TO HOLD THE SAID LAND IN TRUST FOR</u> <u>THE BENEFIT OF ISLANDER INHABITANTS AND FOR NO</u> <u>OTHER PURPOSE WHATSOEVER</u> (Names in full) * as Registered Owners of this land agree to this plan and dedicate the Public Use Land as shown hereon in accordance with Section 50 of the Land Title Act 1994. * as Lessees of this land agree to this plan. Signature of *Registered Owners *Lessees		a. Lodged by (Include address, phone number, reference, and Lodger Code)																
2. Planning Body Approval. * hereby approves this plan in accordance with the : *		<table border="1" style="width:100%; border-collapse: collapse;"> <tr> <th colspan="2">Existing</th> <th colspan="3">Created</th> </tr> <tr> <th>Title Reference</th> <th>Description</th> <th>New Lots</th> <th>Road</th> <th>Secondary Interests</th> </tr> <tr> <td>21298134</td> <td>Lot 3 on TS167</td> <td></td> <td></td> <td>Lease F</td> </tr> </table> <p style="text-align: center;">Lease F does not affect any other leases lodged or registered against CT21298134 as at 12/03/2013</p>		Existing		Created			Title Reference	Description	New Lots	Road	Secondary Interests	21298134	Lot 3 on TS167			Lease F
Existing		Created																
Title Reference	Description	New Lots	Road	Secondary Interests														
21298134	Lot 3 on TS167			Lease F														
3. Plans with Community Management Statement : CMS Number : Name :		7. Orig Grant Allocation : a. Map Reference : 7479-33111 b. Parish : GIACA c. County : Torres 11. Passed & Endorsed : By: RPS Australia East Pty Ltd Date: 12/03/13 Signed: <i>[Signature]</i> Designation: Coastal Surveyor																
4. References : Dept File : Local Govt : Surveyor: PR117006		12. Building Format Plans only. I certify that: * As far as it is practicable to determine, no part of the building shown on this plan encroaches onto adjoining lots or roads. * Part of the building shown on this plan encroaches onto adjoining * lots and * road. Coastal Surveyor/Director * Date * *Please words not required. a. Lodgement Fees : Survey Deposit \$ Lodgement \$ New Titles \$ Photocopy \$ Postage \$ TOTAL \$ 14. Insert Plan Number SP258902																